

A photograph of a field of sunflowers. In the foreground, a single sunflower is in sharp focus, showing its bright yellow petals and dark brown center. The background is filled with more sunflowers, some in focus and some blurred, creating a sense of depth. A solid teal square is positioned in the upper right area of the image, partially overlapping the sunflowers.

The UW Farm

Increasing Sustainability
and Efficiency via a New
Wash Pack at Mercer
Court

Harry Wheldon, Krista Einarsson,
Shae Holmes, Rachel Glessner

The background of the slide is a photograph of a person standing in a garden, watering plants with a red watering can. The person is wearing a white apron over a light-colored shirt and blue jeans. The garden is filled with various green plants and flowers. The image is slightly blurred and has a soft, warm tone. The text is overlaid on the image in a white, sans-serif font.

1. ABOUT THE UW FARM

Student-powered urban
farm on the University of
Washington

2. OBJECTIVE

Finalize mini wash-pack
design and create a grant
proposal for it

3. METHODS

Analyze multiple
environmental benefits and
compare to Charlie's
Produce; cost analysis; and
create grant proposal

4. RESULTS

Saved emissions, water,
time and money; cost is
calculated; and proposal is
done and there are multiple
potential funders

ABOUT THE UW FARM

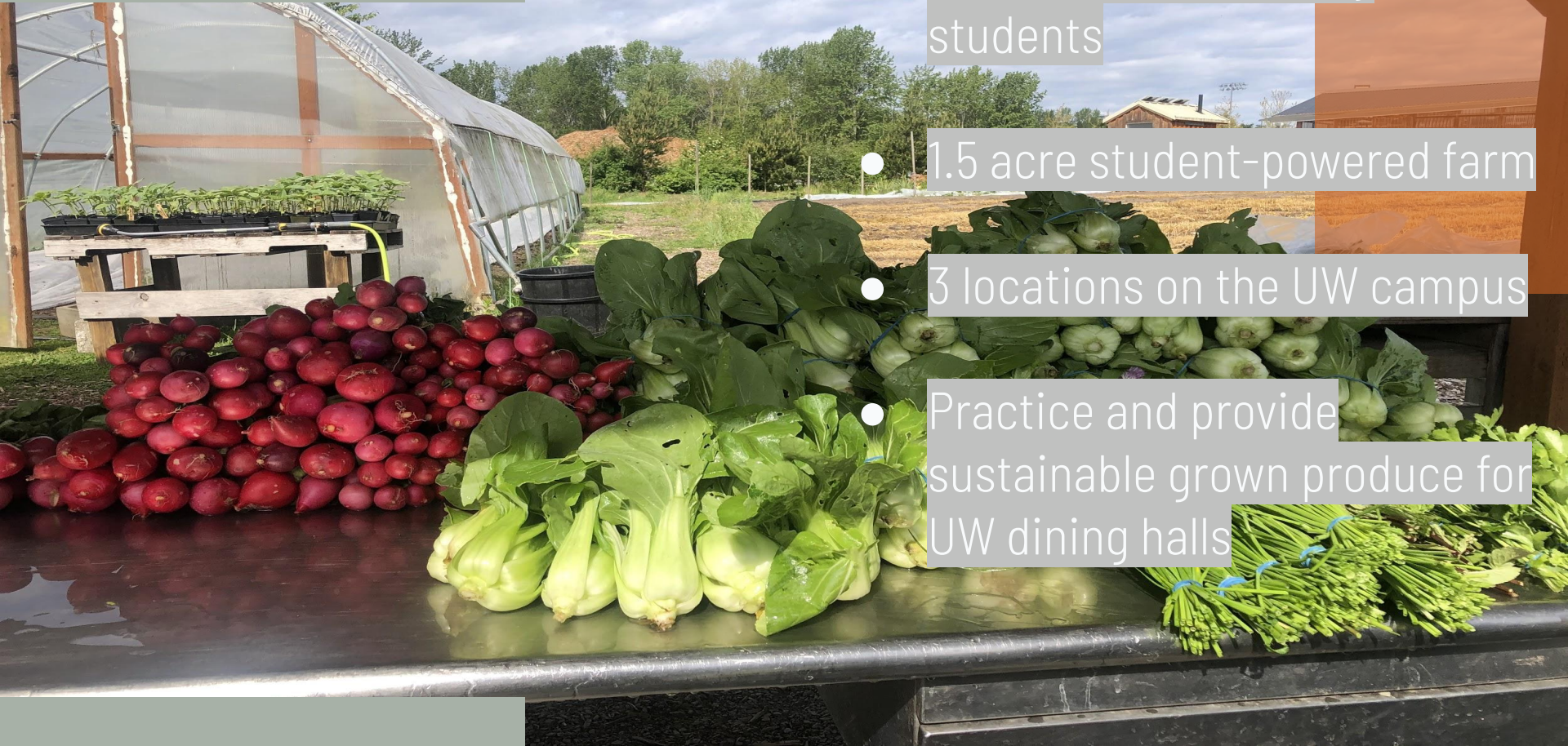

- Established in 2006 by students
- 1.5 acre student-powered farm
- 3 locations on the UW campus
- Practice and provide sustainable grown produce for UW dining halls

LOCATIONS



Mercer Court



Center For Urban
Horticulture



McMahon Hall

Center For Urban Horticulture



Mercer Court



McMahon Hall



Mercer Court

McMahon Hall

Center for Urban Horticulture (CUH)

KEY TO MAP SYMBOLS

- | | |
|-------------------------------------|--------------------|
| Building | Campus Entrances |
| Building (underground) | Bus Stop |
| Path/Sidewalk/Walkway | Bus Route |
| Bridge/Overpass | Emergency Phone |
| E5 Campus Parking Area | Pay Phone |
| P Public Parking Area | Branch Library |
| Parking (underground) | Bank Machine |
| Gatehouse (with emergency phone) | Road Gate |
| Automatic Parking Gate | Fence |
| One Way Road (arrow indicates flow) | Construction Area |
| | Removable Bollards |

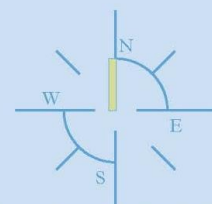

University of Washington
Campus & Vicinity
August 2010



©2010 UW Creative Communications & UW Facilities Services
<http://www.washington.edu/locate/>
Not for commercial purposes

UW Farm at Mercer Court

Location of
new wash pack

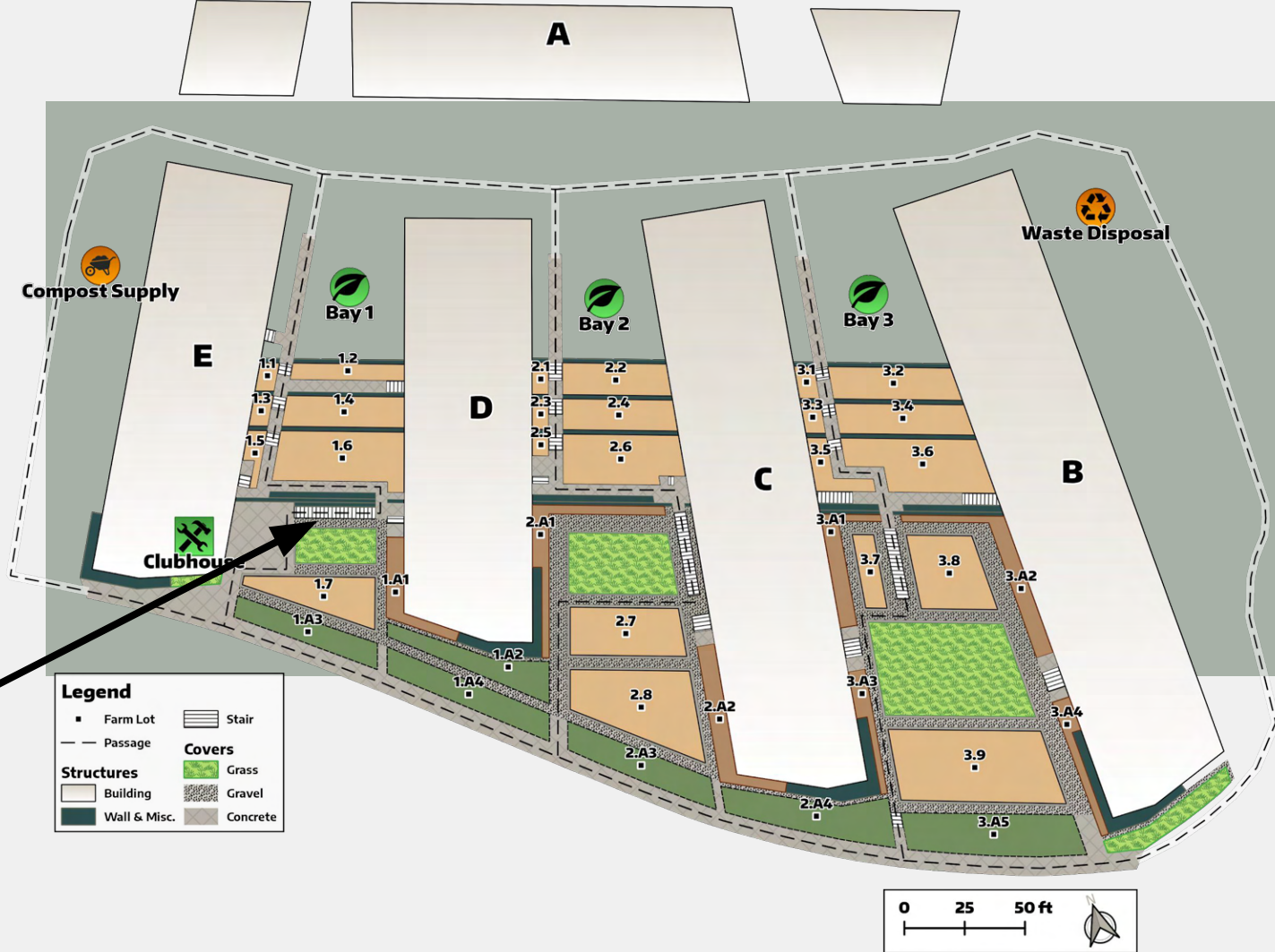

OBJECTIVES

1. To create a grant proposal to receive funding for a mini-wash pack.
1. Finalize mini-wash pack design and source materials.



WASH & PACK STATION



Wash and Pack Stations are a designated spot where you can safely clean, sanitize, and rinse produce to prepare for delivery.



Issue:

Currently the only UW farm Wash and Pack station is located at their CUH site, 2 miles away from Mercer Court.



MERCER COURT MINI WASH PACK DESIGN

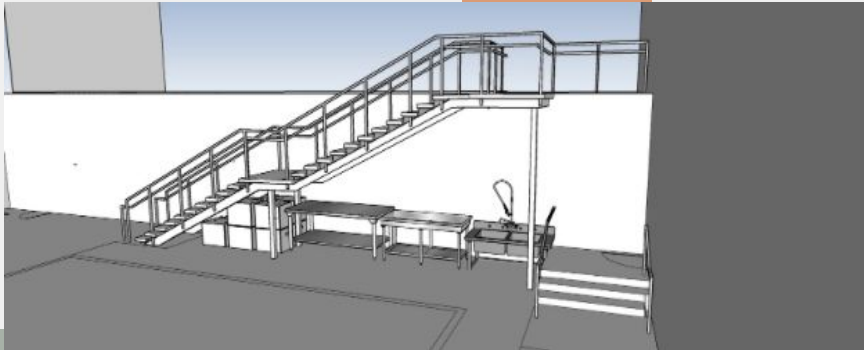
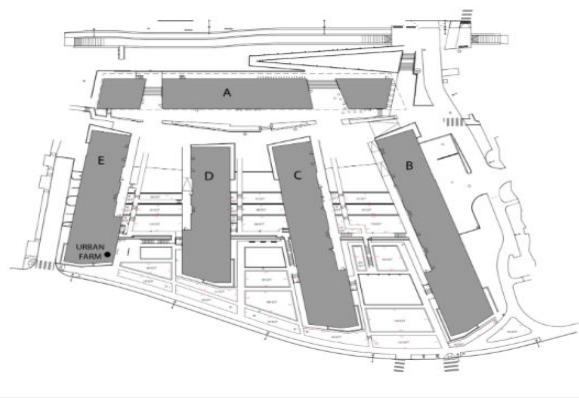

METHODS

1. Analyze Environmental Benefits & Compared to Charlies Produce

We conducted research to analyze how installing a wash pack at Mercer Court would positively impact the farms environmental footprint



2. Prepare Materials Cost Analysis

We prepared and sourced a materials list to instal the wash pack with estimations on item costs.



3. Create A Grant Proposal

We collaborated to write a grant proposal to help source funding for the wash pack.

UW Farm Mini Wash Pack Grant Proposal

University of Washington
1410 NE Campus Parkway Seattle, WA 98195
Prepared By: Krista Einarsson, Harry Wheldon, Rachel Glesner, Shae Holmes
Edited By: Perry Acworth
May 25th, 2020

ENVIRONMENTAL IMPACTS RESULTS

- Reduces CO2 Emissions

574.77 lbs

Estimated CO2 Savings Per Year

- Saves Water Usage

21,318 gallons

Estimated Recycled Water Savings Per Year

2 hours

Estimated Time Savings Per Week

How does UW Farm Compare to Charlie's Produce?



Less Carbon
Emissions → More Local!



More water efficient



More Time Savings



MATERIALS COST ANALYSIS RESULTS

10

Potential Funders

\$86

Total Savings Per Year

\$9,376.42

Total Cost

Estimated Cost Analysis

Description	Notes	Amount
3-Basin Wash Sink	Regency 124" 16-Gauge Stainless Steel Three Compa	\$773.00
Hand Washing Sink	<u>12" x 16" Wall Mounted Hand Sink with Gooseneck I</u>	\$55.00
Flexible Pipe for Directing Water	HydroMaxx 3 in. x 50 ft. Black PVC Schedule 40 Flexible Pipe	\$228.50
PVC Pipe for Sink Drainage	2 in. x 10 ft. 280-PSI Schedule 40 PVC DWV Plain E HydroMaxx 2 in. Schedule 40 PVC Pipe Tee Fitting X HydroMaxx 2 in. Schedule 40 PVC Pipe 90-Degree E	\$34.37
Pipe Fittings	Needs a direct size for pipe fittings	\$25.00
Faucet for 3-Basin Wash Sink	Regency Wall Mount Faucet with 14" Swing Spout, 2 GPM Aerator, 8" Centers, and Lever Handles	\$41.59
Foldable Table	Sparrow Peak 48-in W x 20-in H Hardwood Work Bench	\$105.00
Foldable Fence	Estimae from All City Fence	\$7,081.96
Garden Hose	FLEXON 5/8-in x 50-ft Light-Duty Vinyl Green Hose	\$10.00
Attachable White board	MagFlex Lite MFLA4(GWD)-1 Flexible A4 Magnetically Attachable Whiteboard Sheet (297 x 210 x 0.76mm) (Pack of 1)	\$22.00
Miscellaneous/Plumber	Extra funds	\$1,000.00
		\$9,376.42

NEXT STEPS

1. Submission Of Grant Proposal For Review



2. Make Necessary Adjustments to Grant Proposal



3. Submit Proposal to Potential Funders



RECOMMENDATIONS



Implement Better Water Catcher

1. Include a cistern to collect rainwater and excess wash pack water



Promote Environmental Impacts

2. Create promotional material for the UW Farm or HFS with the environmental benefits of the wash pack.



Expand Fencing to All Stairwells

1. Expand the fencing system to be underneath each stairwell in Mercer Court

A person wearing a white apron over a dark top and blue jeans is standing on a concrete path in a nursery. They are holding a bright orange watering can and watering various potted plants. The plants include flowering shrubs and palm trees. The scene is outdoors with natural light.

THANKS!

& A SPECIAL THANKS TO
PERRY ACWORTH AND ALEXA
SCHREIER

Does anyone have any
questions?